

Label	Units	Avg	Max	Min	Avg/Min	Max/Min	PtSpLcr	PtSpCb
BUILDING 1	Fc	1.48	4.6	0.2	7.40	23.00	20	20
BUILDING 1 & 2 ENTRANCE	Fc	2.09	4.4	0.4	5.23	11.00		
BUILDING 2	Fc	1.46	4.7	0.3	4.87	15.67		
BUILDING 3	Fc	1.29	4.6	0.1	12.90	46.00		
BUILDING 4	Fc	1.48	4.3	0.2	7.40	21.50		

Symbol	Qty	Label	Total Lamp Lumens	LLF	Description	Lum. Watts
	12	A	N.A.	0.950	WLS-MIR-5W-LED-HO-50 27' POLE 3' BASE	244
	53	B	N.A.	0.950	WLS-MIR-FT-LED-HO-50 27' POLE 3' BASE	241.3
	4	C	N.A.	0.950	WLS-MIR-2-LED-HO-50 27' POLE 3' BASE	241
	5	D	N.A.	0.950	WLS-MIR-FT-LED-HO-50-IL 27' POLE 3' BASE	241.3
	115	E	N.A.	0.950	WLS-MIRW-FT-LED-08-50 16' MOUNTING HEIGHT	76

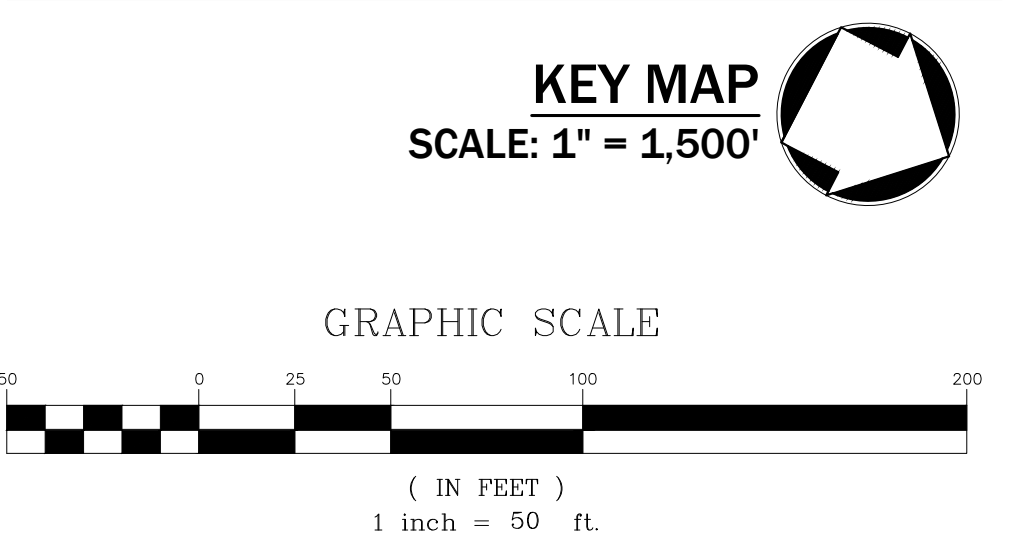

NOTES:
 1. ALL CABLES AND WIRING SHALL BE INSTALLED UNDERGROUND IN CONDUIT. CONDUIT SHALL BE SCHEDULE 40 PVC CONDUIT INSTALLED WITH TWO (2) FEET OF COVER. MINIMUM SIZE OF CONDUIT SHALL BE TWO (2) INCH DIAMETER.

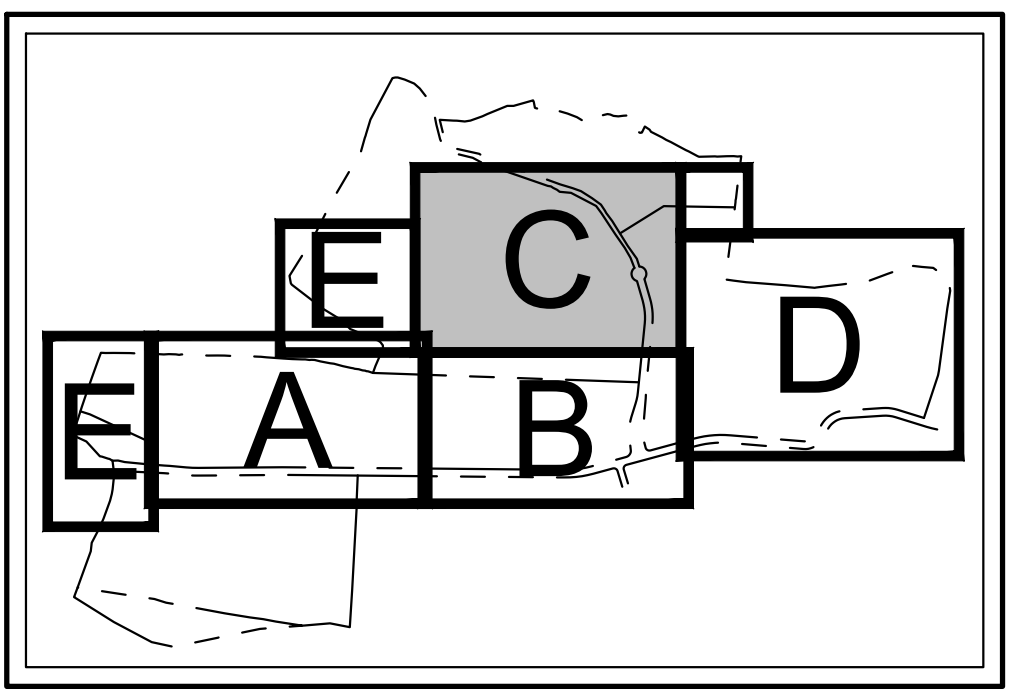
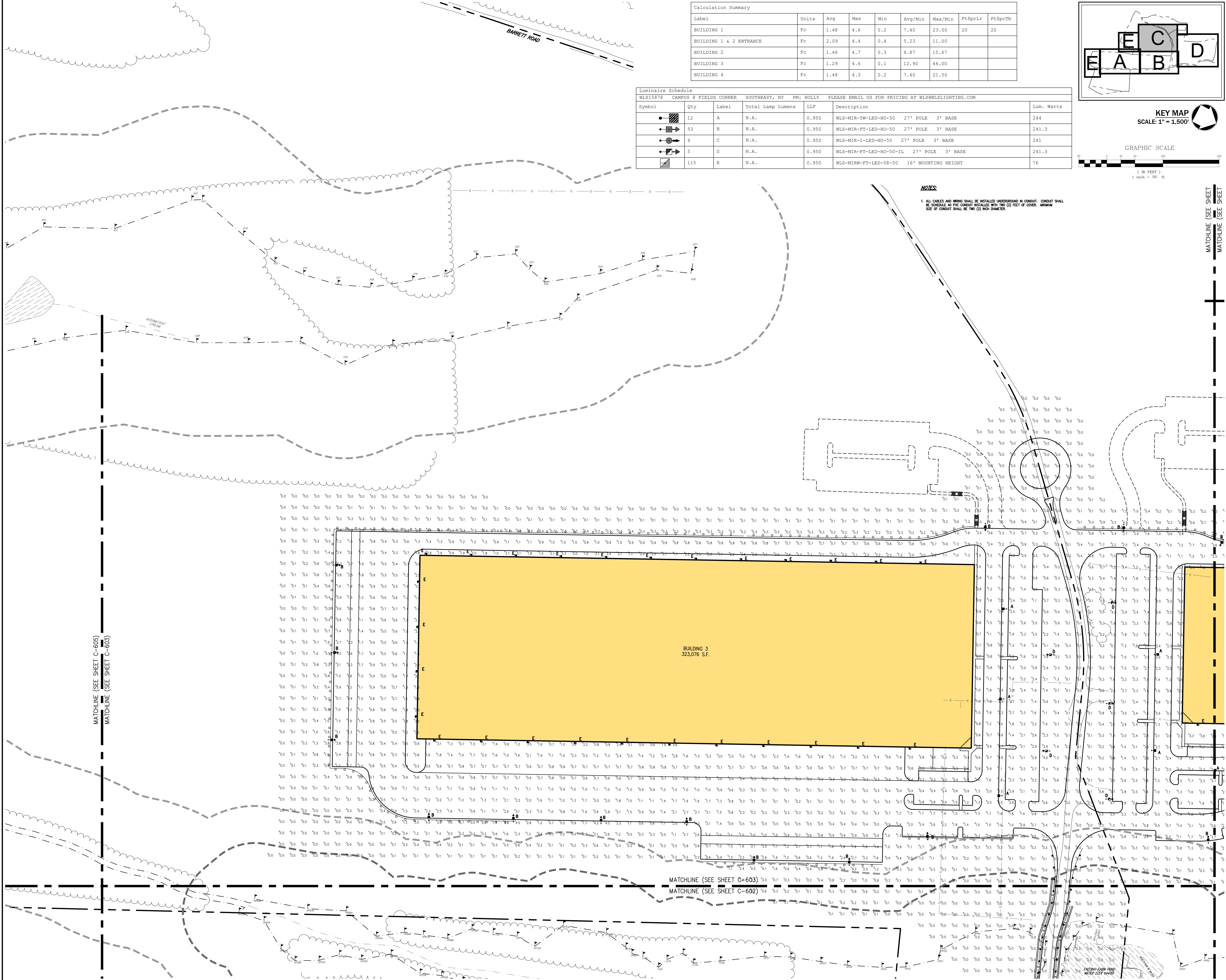

NOT FOR CONSTRUCTION

MATCHLINE (SEE SHEET C-605)
 MATCHLINE (SEE SHEET C-603)

MATCHLINE (SEE SHEET C-603)
 MATCHLINE (SEE SHEET C-602)

By: **KRM**
 Date: **05/17/2018**
 Revision: **1**
 Description: **REVISIONS**

APPLICANT/OWNER: **PUTNAM SEABURY PARTNERS, L.P.**
 287 KING STREET
 CHAPPAQUA, NY 10514

JMC Planning, Engineering, Landscape Architecture & Land Surveying, LLC
 JMC Site Development Consultants, LLC
 John Meyer Consulting, Inc.
 123 BEVERLY DR. - HERRING, NY 13343
 PHONE: 518.233.5255 - FAX: 518.272.1212
 www.jmcplc.com

JMC

LIGHTING PLAN 'C'
 NORTHEAST INTERSTATE LOGISTICS CENTER
 TOWN OF SOUTHEAST, NEW YORK

ANY ALTERATION OF PLANS, SPECIFICATIONS, PLATS AND REPORTS BEARING THE SEAL OF A LICENSED PROFESSIONAL ENGINEER OR LICENSED LAND SURVEYOR IS A VIOLATION OF SECTION 7209 OF THE NEW YORK STATE EDUCATION LAW, EXCEPT AS PROVIDED FOR BY SECTION 7209.1 SUBSECTION 2.

Drawn: **KRM** Approved: **R.P.**
 Scale: **1" = 50'**
 Date: **11/06/2017**
 Project No: **14012**
 Drawing No: **LIGHTING C (LIGHTING PLAN)**
 Drawing Title: **C-603**